

FOR SALE
Townhome



\$459,000

3 2.5 2

LOT

HOUSE AREA 182m²

KEY FEATURES

- Gas cooking, island benchtop and Bosch appliances
- Double lock up garage plus storage
- Combined living and dining spilling onto the covered alfresco
- Three generous bedrooms on the upper level with the master suite featuring a walk-in-robe and ensuite
- Full size bathtub and walk in shower in the main bathroom
- Separate laundry room and powder room
- Pet friendly



*Price correct at time of printing and subject to change. Price does not include stamp duty, registration fees or any other incidental fees. Subject to availability. All floor plans are indicative only. All areas are approximate. Cars, furniture, decorative items, plants and the like are shown for indicative purposes only and are not included in the sale. The contract for sale should be reviewed in relation to dimensions, areas, sale inclusions and specifications. Information and images relating to landscaping are indicative only and may show mature plantings which may not be mature at settlement. The content of this brochure is based on the intention of, and information available to, Stockland as at 4/03/2020 and may change due to future circumstances. Price correct as at 03/03/2020. Visit stockland.com.au for full Terms & Conditions.



Contact:

Scott Hammond +61 435-777-845
Email: s.hammond@rwsp.net

\$459,000

3 2.5 2

LOT

HOUSE AREA 182m²



NORTH



Ground Floor



First Floor

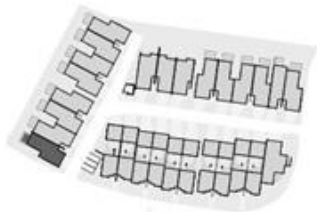

Foreshore Townhomes

LOT 1

3 2.5 2

KURRAWA

House Area

Ground Floor 63m²

First Floor 70m²

Alfresco 11m²

Garage 38m²

Total House Area 182m²

External Area

Back Yard 98m²

0m 5m



This document is supplied solely for the purpose of providing an indicative floor plan of the nominated lot within the proposed development called "Foreshore Townhomes" and is not intended to be used for any other purpose. The contents of this document are based on information available to Stockland at the time of creation (September 2019). Unless otherwise specified, dimensions are taken from the midline of walls. All dimensions and areas are approximate. Cars, furniture, decorative items and plants are shown for indicative purposes only and are not included in the sale. The contract for sale should be reviewed in relation to dimensions, areas, site inclusions and specifications. Stockland reserves the right to make changes, without notice, to the information contained in this document at any time prior to you entering into a contract for sale with Stockland. If this document is included in a contract for sale, Stockland reserves the right to make changes to the information contained in this document in accordance with the terms of the contract for sale. Information and images relating to landscaping are indicative only and may show plantings which may not be mature at settlement. No liability is accepted for any loss or damage arising from the improper use or reliance on this document or its contents.